

TORO

Count on it.

EVOLUTION® Series Add-On: *EVO-SC Smart Connect® Installation*

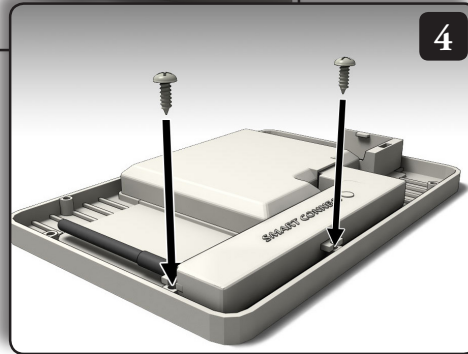
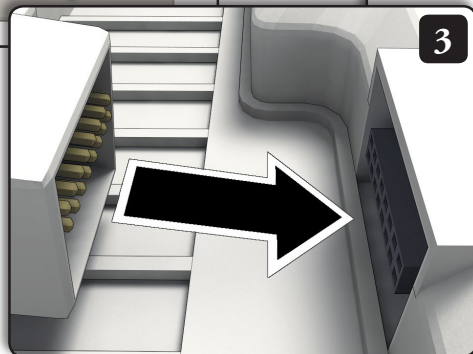
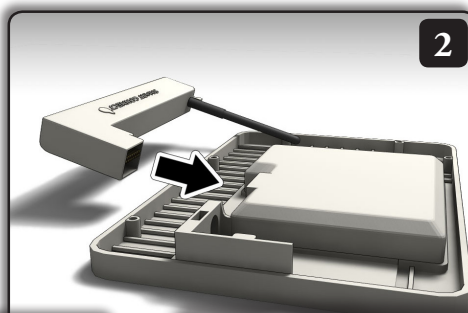
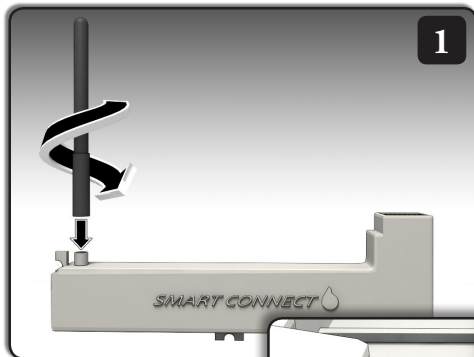

For more information on the EVOLUTION controller and integrated accessories, please go to www.toro.com/evolution (US and Canada) or www.toroevolution.com (international).

Technical Information

Specifications

- Dimensions:
6.5" (16,5 cm) wide x 6" (15,2 cm) high (over 3.75" [9,5 cm] antenna x .75" (1,9 cm) deep
- receives power from controller
- RF reception range:
500'-1000' (152-305 m) LOS (line of sight)
depending on equipment used
- Operating temperature range:
14° – 140° F (-10°– 60°C)



FCC-ID: OF7ESC
IC: 3575A-ESC

FCC Part 15 Rules

This equipment has been tested and found to comply with the limits for a Class B digital device, pursuant to Part 15 of the FCC Rules. These limits are designed to provide reasonable protection against harmful interference in a residential installation. This equipment generates, uses and can radiate radio frequency energy and, if not installed and used in accordance with the instructions, may cause harmful interference to radio communications. However, there is no guarantee that interference will not occur in a particular installation. If this equipment generates interference to radio or television reception, which can be determined by turning the equipment on and off, the user is encouraged to try to correct the interference by one or more of the following measures:

1. Reorient or relocate the receiving antenna.
2. Increase the separation between the equipment and receiver.
3. Connect the equipment into an outlet on a circuit different from that to which the receiver is connected.
4. Consult the dealer or an experienced radio/TV technician for help.

The user may find the following booklet prepared by the Federal Communications Commission helpful: "How To Identify and Resolve Radio-TV Interference Problems". This booklet is available from the U.S. Government Printing Office, Washington, DC 20402. Stock No. 004-000-00345-4.

Australian Warranty Statement

This product comes with a manufacturer's guarantee against defects in material and workmanship when used for its intended purpose. Our obligation under this guarantee is limited to the repair or replacement of the product at our discretion for the period stated. In the event of a claim, you must immediately cease using the product and return the product, together with your proof of purchase and an explanation of the fault to the store you purchased it from. All costs associated with the return of the product are the purchasers' responsibility. To process the warranty, the retailer must contact Toro Australia via their representative or the phone number listed below.

Our goods come with guarantees that cannot be excluded under the Australian Consumer Law. You are entitled to a replacement or refund for a major failure and for compensation for any other reasonably foreseeable loss or damage. You are also entitled to have the goods repaired or replaced if the goods fail to be of acceptable quality and the failure does not amount to a major failure.

Toro Australia Pty Ltd, 53 Howards Road, Beverley SA 50091300 130 898,
info.au@toro.com

Technical Support: 1-877-345-8676 (US & Canada)
evolution@toro.com (international)

©2014 The Toro Company, Irrigation Division • www.toro.com
Form Number 373-0812 Rev. B