

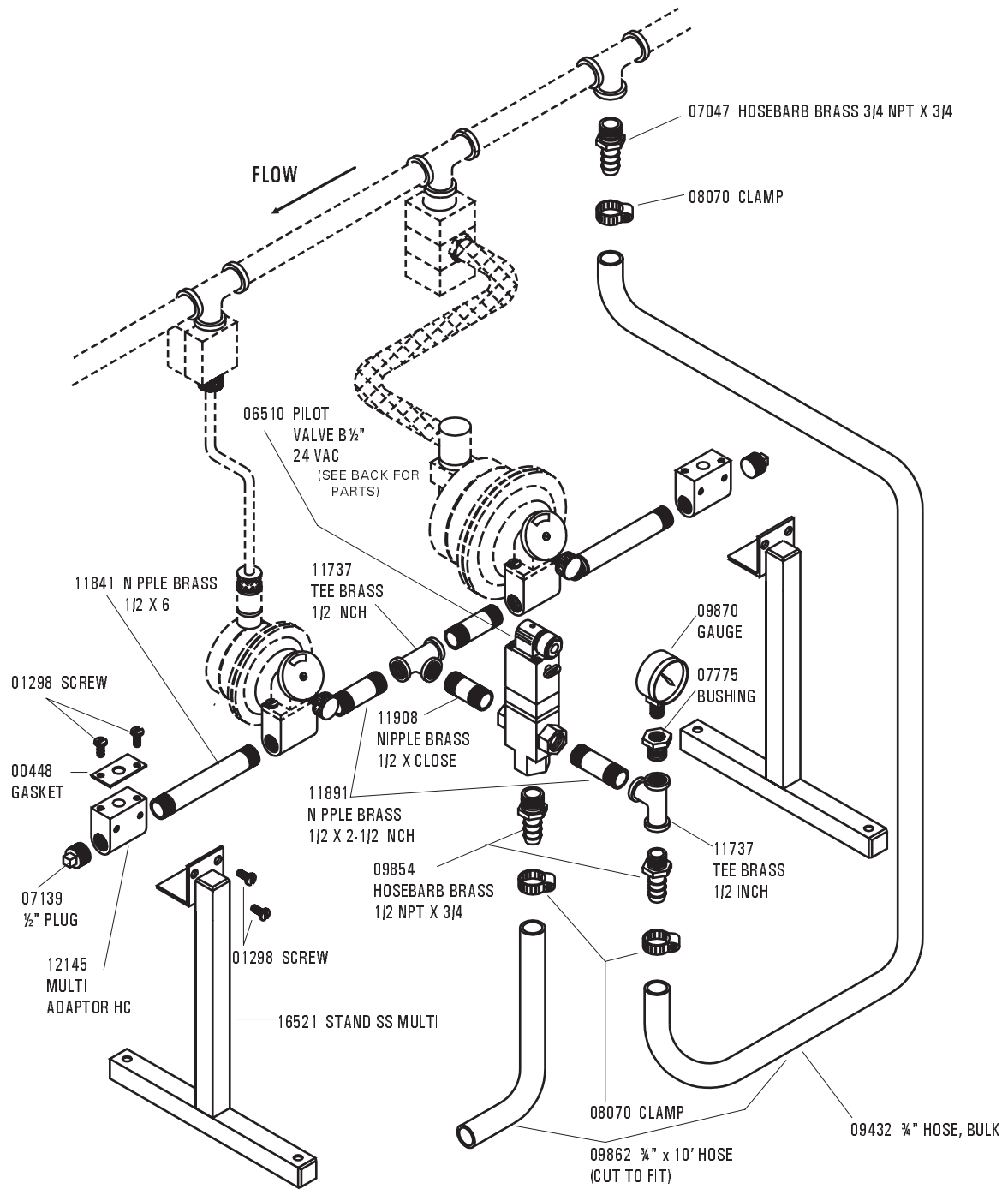

H.E. Anderson
COMPANY
Muskogee, OK. 74402-1006

ELECTRIC ACTUATED MANIFOLD PARTS (1/2" Type B Valve)



05306 SEAL KIT 1/2

Contains:

1 ea.	05025*	1 ea.	05158
1 ea.	05166	1 ea.	05174
2 ea.	05190	1 ea.	05257
3 ea.	05273	1 ea.	05299

* Not used with electric valve

ORIFICE ADJUSTING PROCEDURE

Refer to Part number 05954 BBLOCK ASSY and the 0265 ACTUATOR BLOCK. On the 'R' side the 05330 ACTUATOR ORIFICE screws in 1 ¼ turns from flush. The 'P' side adjusts 2 turns in from level or flush with the block.

MANIFOLD VALVE PARTS

For ½" Type B Valve

24 VAC, P/N 06510

12 VDC, P/N 06502

