

Variante A / A Option

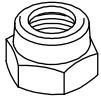

2 x 73.605.68

Variante B / B Option



2x73.605.28

Variante C / C Option

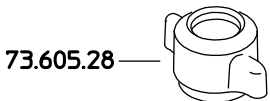

73.605.28

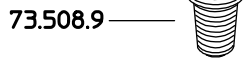

73.508.9

2x73.815.7

Variante E / E Option

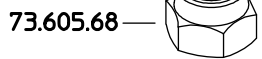

73.605.68

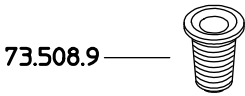

73.508.9

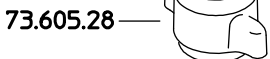

73.605.28

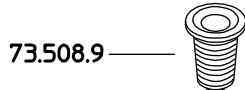

73.508.9

73.815.5

Variante F / F Option

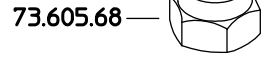

73.605.68

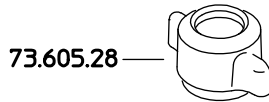

73.605.28

Variante standard / Standard option

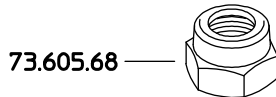

73.605.68

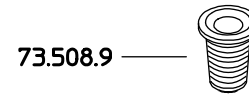

73.508.9

73.815.8

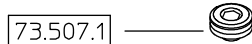

73.507.1

Sigilla filetti  
anaerobico

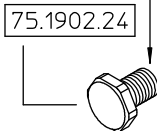

75.1902.24

73.507.1

Variante standard / Standard option

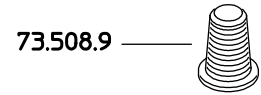

73.508.9



73.605.68

73.815.8

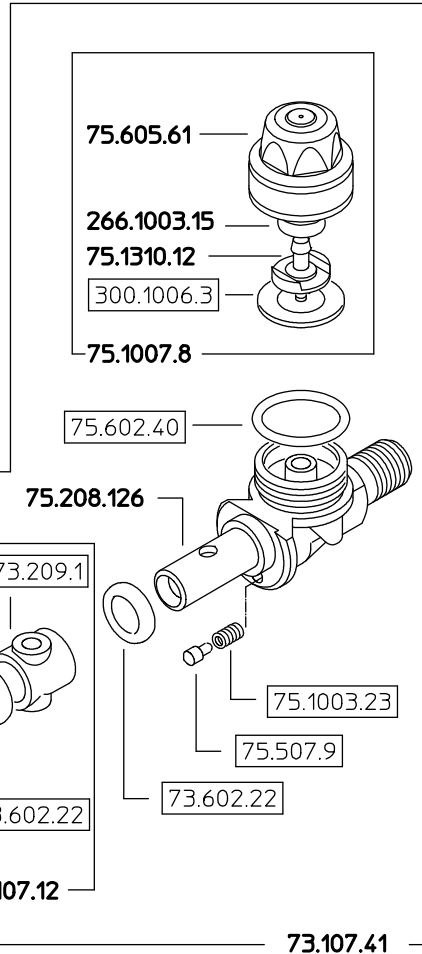

75.605.61

266.1003.15

75.1310.12

300.1006.3

75.1007.8

75.602.40

75.208.126

73.208.62

73.209.1

75.1003.23

75.507.9

73.602.22

73.107.12

73.107.41

**73.617.33 A/B/C/E/F**

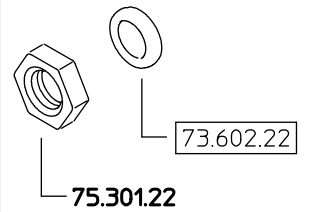

75.301.22

Solo per kit  
Only for kit



23.602.34 X2

68.602.10

73.602.22 X2

260.602.14 X2

Come si ordina/How to order  
Kit ricambio  
Spare parts kit **75.302.28**

|                                                               |                                                                                                                      |                           |                                    |
|---------------------------------------------------------------|----------------------------------------------------------------------------------------------------------------------|---------------------------|------------------------------------|
| DENOMINAZIONE: <b>Getto M73 antigoccia 11/16 16UN G1/4 M.</b> |                                                                                                                      | N°revisione:<br><b>03</b> | Data revisione:<br><b>23/11/10</b> |
| <b>Braglia</b> SRL                                            | Tel. ++39 0522 340648<br>Fax. ++39 0522 345025<br>E-mail: <a href="mailto:braglia@braglia.it">braglia@braglia.it</a> | STE                       | RTE                                |
| Dis.N°/Codice<br><b>73.617.33</b>                             |                                                                                                                      |                           |                                    |