

H Series

REPAIR PARTS / RH R1



Part No.	Part Name	Pattern No.
7K79	Spline protector	
7K411	Bearing - bowl	
7K566	Suction strainer	
7K642	Motor adapter 6"	57213
7K645	Discharge head - 3" NPT	57214
7K651	Shaft sleeve - 2 required per stage	
7K654	Shaft sleeve - lower	
7K707	Discharge head - 4" NPT	59039
7K794	Motor adapter 4"	59048
	100H stage assembly	
7K796①	100H bowl with marine bearing effective November 1990	59046
7K798	100H impeller - full dia. (5 HP, 10 HP, 20 HP, 25 HP)	59044
7K1252	100H impeller - cut dia. (7½ HP and 15 HP)	59044
7K802	100H bowl wear ring	
7K805	100H wear ring (motor adapter)	
	150H stage assembly	
7K797②	150H bowl with marine bearing effective June 1991	59045
7K799	150H impeller	59043
7K806	150H bowl wear ring (use with bowl pattern 59045)	
7K806	150H wear ring (motor adapter)	
	225H stage assembly	
7K797	225H bowl with marine bearing	59045
7K800	225H impeller - full dia.	59042
7K801	225H impeller - cut dia. (5 HP 2 stage only)	59042
7K804	225H wear ring (bowl and motor adapter)	
	275H stage assembly (OBSOLETE)	
7K643	275H bowl with marine bearing	57216
7K644	275H impeller	57215
7K656	275H wear ring (bowl and motor adapter)	
7K646	2 stage - 6" motor	Shaft and Coupling Group
7K647	3 stage	
7K648	4 stage	
7K649	5 stage	
7K650	6 stage	
7K696	8 stage	
7K697	10 stage	
7K703	7 stage	
7K704	9 stage	
7K807	2 stage - 4" motor	
7K808	13 stage	

Part No.	Part Name	Pattern No.
7K657	2 stage	Cable Guard Group NOTE: Repair cable guards do not have holes. Use with new style clamps 13K173.
7K658	3 stage	
7K659	4 stage	
7K660	5 stage	
7K661	6 stage, 275H (OBSOLETE)	
7K698	8 stage, 275H (OBSOLETE)	
7K701	7 stage, 275H (OBSOLETE)	
7K702	9 stage, 275H (OBSOLETE)	
7K809	6 stage, 100H, 150H, 225H	
7K810	7 stage, 100H, 150H, 225H	
7K811	8 stage, 100H, 150H, 225H	
7K812	9 stage, 100H, 150H, 225H	
7K813	10 stage	
7K814	13 stage	
13K114	Hex nut - 4" motor	
13K117	Lock washer - 4" motor	
13K122	Strainer screw	
13K128	Locker washer - 6" motor	
13K130	Hex bolt - 6" motor	
13K169	Cotter pin	
13K173	Cable guard clamp	

Stages by Model and Horsepower

HP	5	7½	10	15	20	25	30	40
100H	2	4*	5	8*	10	13	-	-
150H	2	3	4	6	8	10	-	-
225H	2*	2	3	4	6	7	8&9	-
275H**	-	-	2	3	4	5	6&7	8&9

*4 stage 100H, 7½ HP and 8 stage 15 HP uses cut diameter impellers.

*2 stage 225H, 5 HP uses cut diameter impellers.

** OBSOLETE

NOTE: Highlighted 275H parts are available while supplies last. Product Series 275H obsolete as of January 1, 2020.

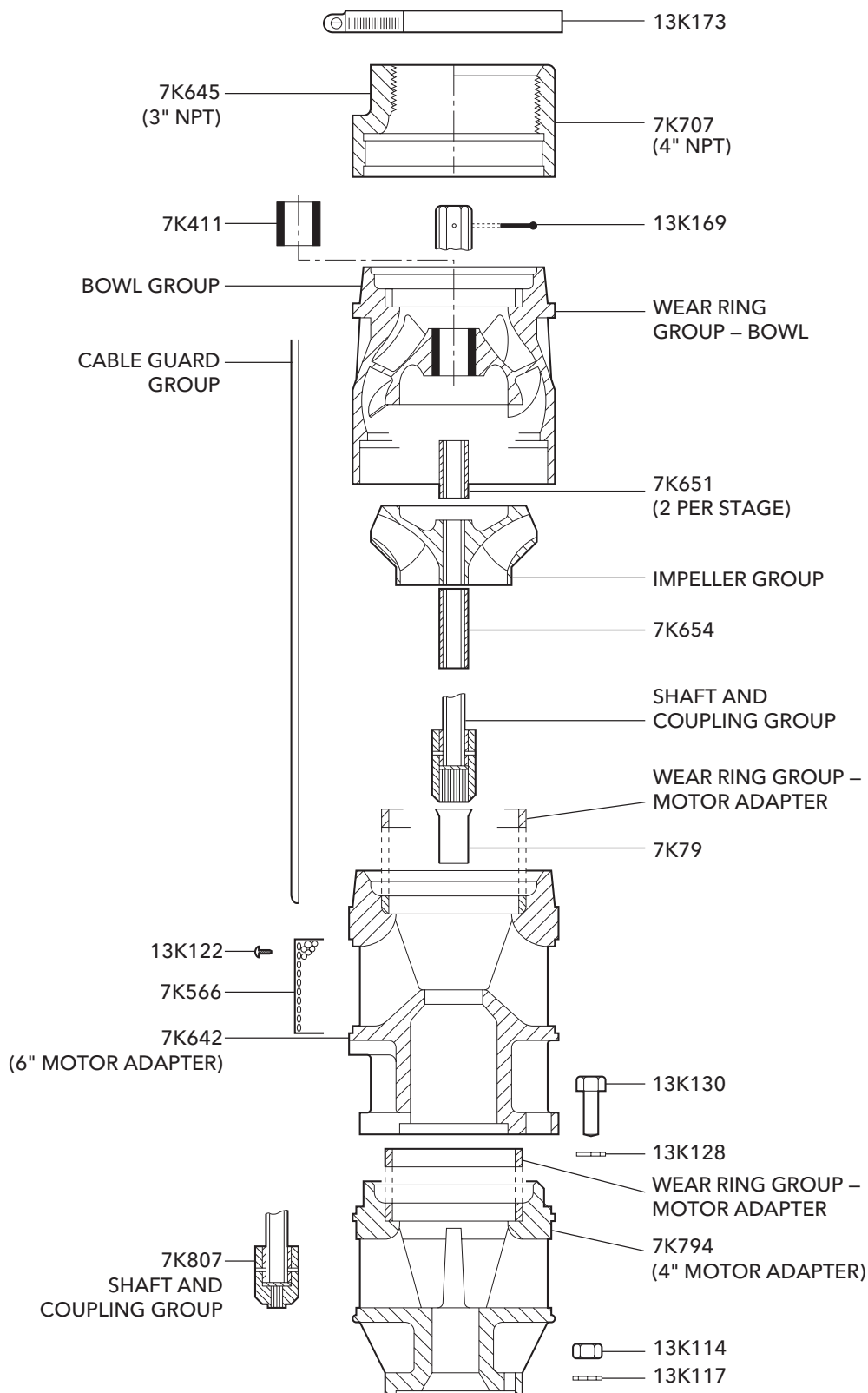

Xylem Inc.
www.xylem.com/goulds

Goulds is a registered trademark of Goulds Pumps, Inc. and is used under license.
 © 2019 Xylem Inc. RH R1 August 2019

