

Features of the DWT

Discharge Head

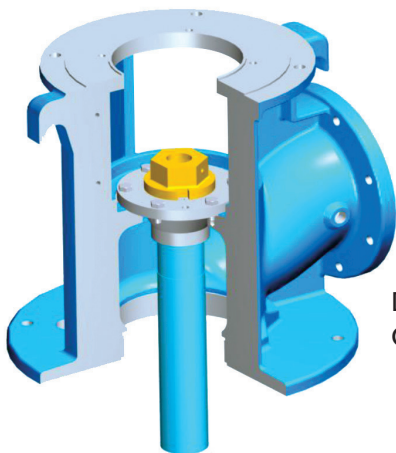

Ductile Iron-
Oil Lube head

Column Assembly

Lineshaft — High strength steel. Ground and polished for exact bearing fit.

Enclosing Tube — Extra heavy steel tubing for positive bearing alignment.

Enclosed Lineshaft Bearings — Bronze Construction – High strength bearing bronze, spiral grooved for positive lubrication.

Column Pipe and Couplings — Parallel thread, accurately machined for easy installation, accurate alignment.

Tube Centering Spider — Stabilizes enclosing tube for smoother operation.

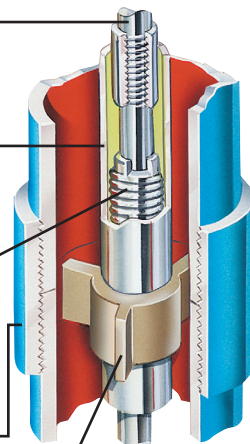

Bronze
Construction

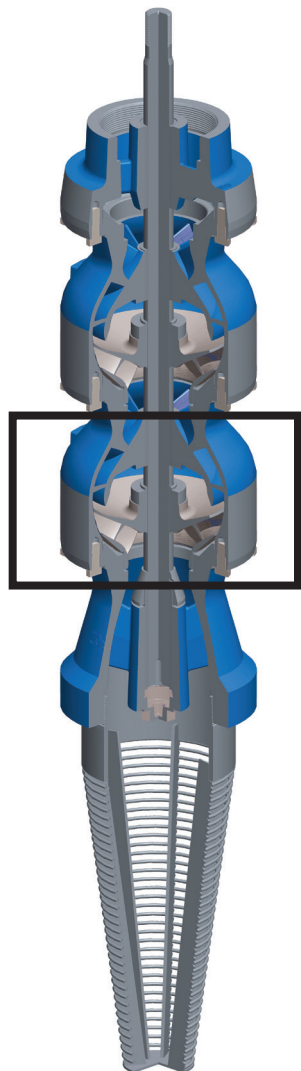

Glass Lined Bowls

Heavy-duty Class 30 cast iron intermediate bowls with standard feature of lined waterways for maximum efficiency and wear protection.



Optional Long Lateral

Long lateral adjustment for maximum setting capabilities. Available in some sizes.

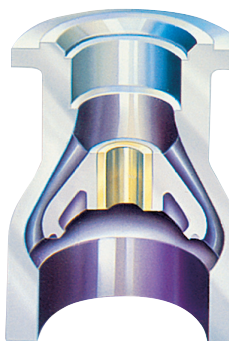

Impellers

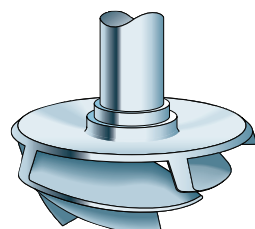

Semi-Open Impeller

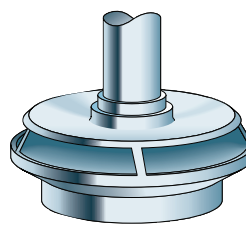

Closed Impeller

Features of the VIS

Discharge Bearing - Extra long top protected bronze bearing insures positive shaft alignment and stabilization for extended life.

Impellers - Designed for maximum efficiency with wide range hydraulic coverage. Precision balanced for smooth operation.

Lock Collets - Accurately machined to insure positive locking of impeller to pump shaft.

Suction Inlet - Contoured for smooth flow entrance. Protected by an oversized stainless steel strainer to prevent entrance of damaging solids.

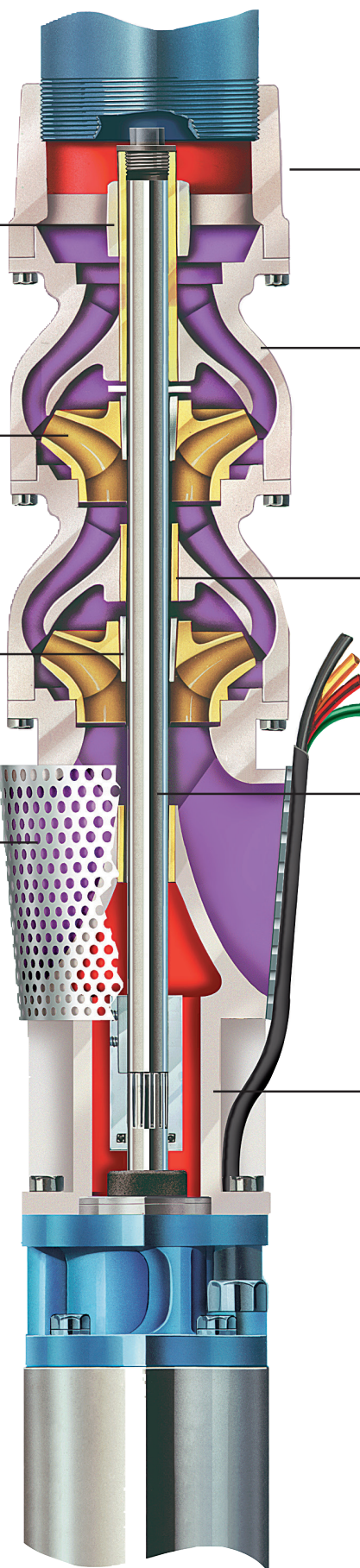

Discharge Bowl - Several discharge sizes available for NPT or flanged connection

Intermediate Bowl - Close grained Class 30 cast iron. Water passage glassed for maximum efficiency and abrasion resistance.

Intermediate Bowl Bearings - Reliable long life bronze or rubber bearing.

Pump Shaft - 100,000 PSI high tensile stainless steel provides strength and excellent corrosion resistance.

Suction Adapter - Ductile iron provides for increased strength and positive motor alignment. Open area permits easy access to pump/motor coupling.